

The West Lodge and Maitland Rooms

DOWNING COLLEGE CAMBRIDGE

(Fig. 1) West Range Ground Floor

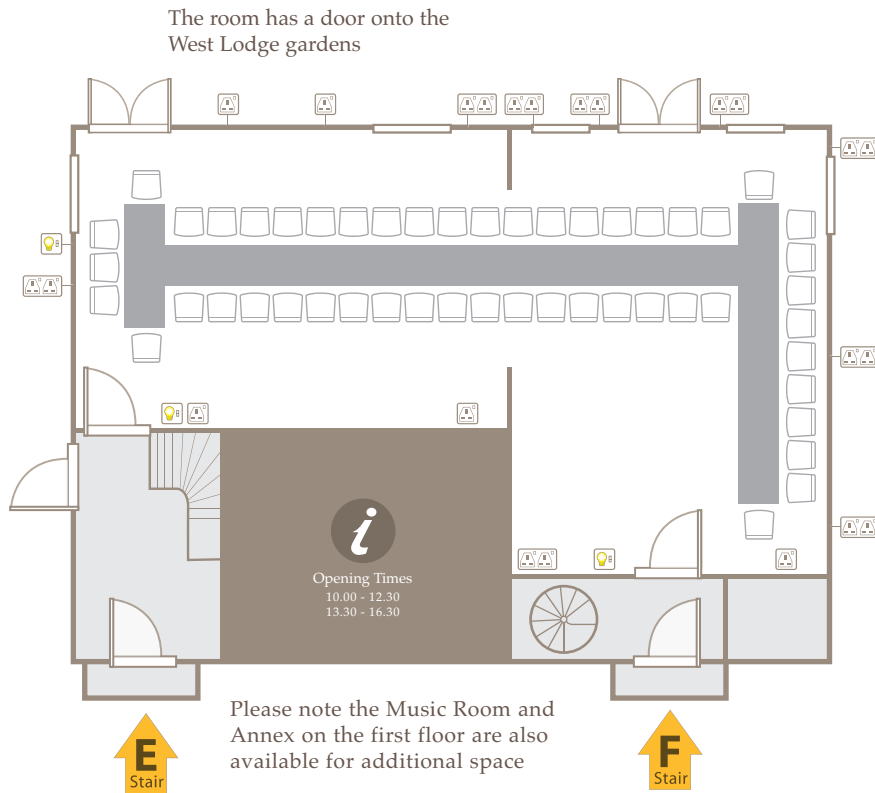

DIMENSIONS

West Lodge 8m x 5m **44m²**

West Lodge 5m x 8m **44m²**

Combined **88m²**

CAPACITY

'T' Shape Diner (Fig. 1) **50**

Lecture Theatre **80**

Classroom **35**

EQUIPMENT

Data projector & Screen, OHP, Mobile PA system, Video and TV, Flip charts

These two adjoining, multipurpose rooms are suitable for smaller seminars or one large when joined. They are particularly ideal for company presentations, private diners, receptions and parties or breakout rooms.

VIEW FROM THE WEST LODGE LOOKING INTO THE MAITLAND ROOM



BOOKINGS

For bookings, please contact the Conference office on **01223 334 860**

FOR A MAP SHOWING THE ROOM'S LOCATION IN THE COLLEGE & ALTERNATIVE ROOM LAYOUTS PLEASE SEE OVERLEAF

West Lodge & Maitland Rooms

DOWNING COLLEGE CAMBRIDGE

▲ FINDING THE WEST LODGE

All visitors are kindly requested to report to the Porters' Lodge. This can be found on the left hand side as you walk through the main college gates on Regent Street.

P PARKING

Once inside the main gate, turn right, pass through the barrier and follow car park along to the 'Conference Parking Area'.

✓ FIRE ASSEMBLY POINT

In the unlikely event of a fire, please note the Fire Assembly Point for the West Lodge and Maitland Room is on the grassed area at the front of the West Range.

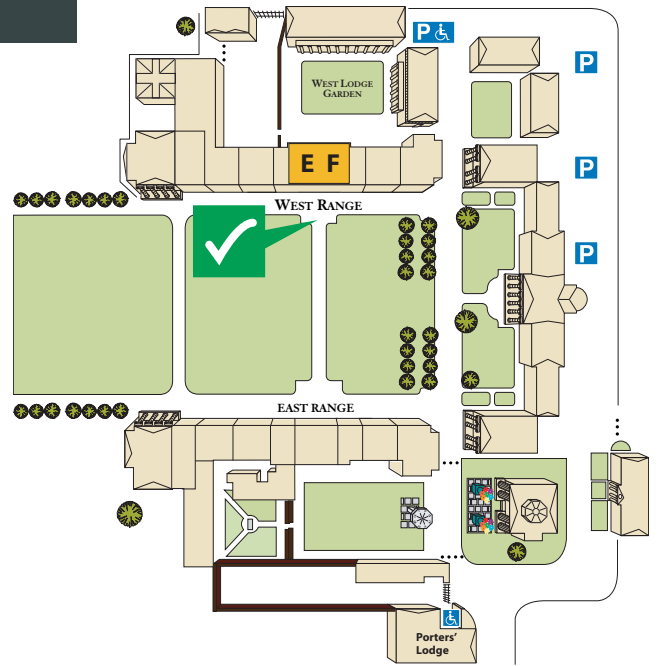

Lecture Theatre 80

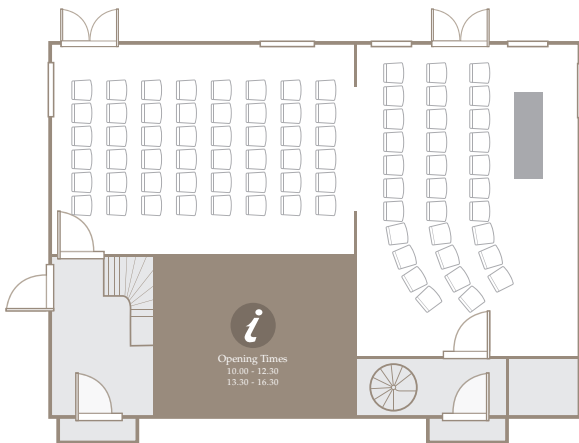

Classroom 35

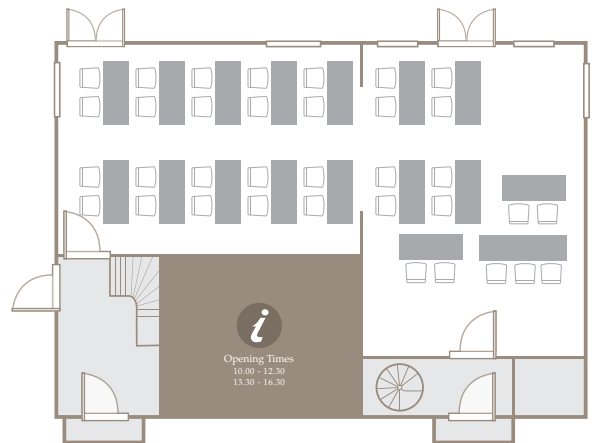

Drinks and Dinner 41

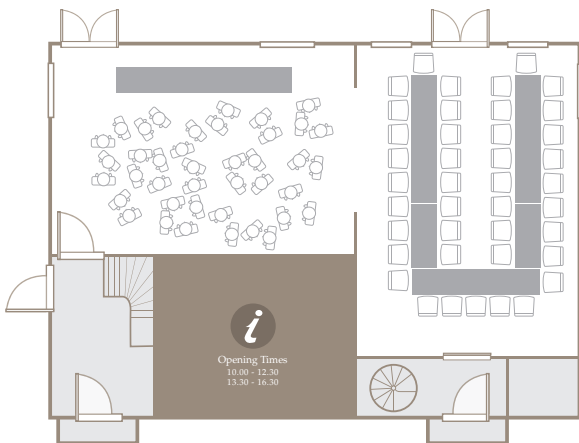

Buffet and Tables 59

