

The Howard Building First Floor

DOWNING COLLEGE CAMBRIDGE

(Fig. 1) Howard Building First Floor

Stairs lead down to the ground floor bar and reception area.

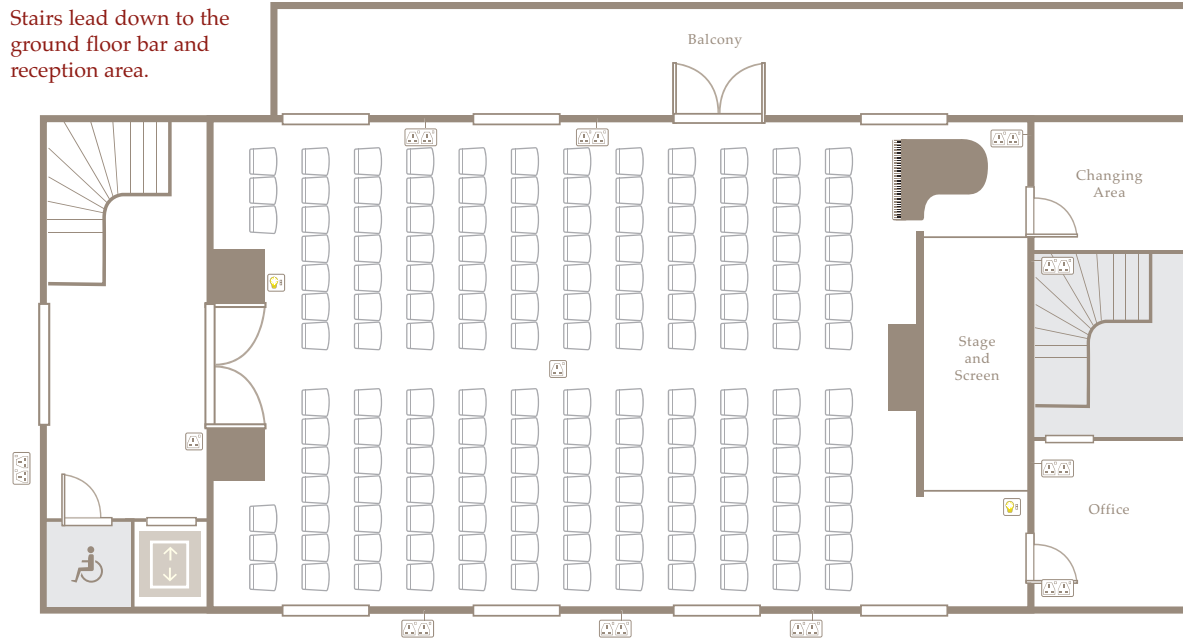

DIMENSIONS

15m x 9m **135m²**

CAPACITY

Theatre (Fig. 1) **160** Standing **180** Classroom **60** Cabaret **42**

EQUIPMENT Data projector and screen, Laser pointer, Microphones - fixed and mobile, PA system, OHP, Slide projector, Video player, Hearing loop, Flip chart, TV

This second floor lecture theatre is fully equipped and a perfect setting for presentations, lectures and other events. Complemented by the ground floor reception and breakout area.

SHOWS THE VIEW FROM THE BACK OF THE ROOM SET UP AS A LECTURE THEATRE



BOOKINGS

For bookings, please contact the Conference office on **01223 334 860**

FOR A MAP SHOWING THE ROOM'S LOCATION IN THE COLLEGE & ALTERNATIVE ROOM LAYOUTS PLEASE SEE OVERLEAF

The Howard Building First Floor

DOWNING COLLEGE CAMBRIDGE

▲ FINDING THE HOWARD BUILDING

All visitors are kindly requested to report to the Porters' Lodge. This can be found on the left hand side as you walk through the main college gates on Regent Street.

P PARKING

Once inside the main gate, turn right, pass through the barrier and follow car park along to the 'Conference Parking Area'.

✓ FIRE ASSEMBLY POINT

In the unlikely event of a fire, please note the Fire Assembly point for the Howard Building is on the grassed area at the front of the building.

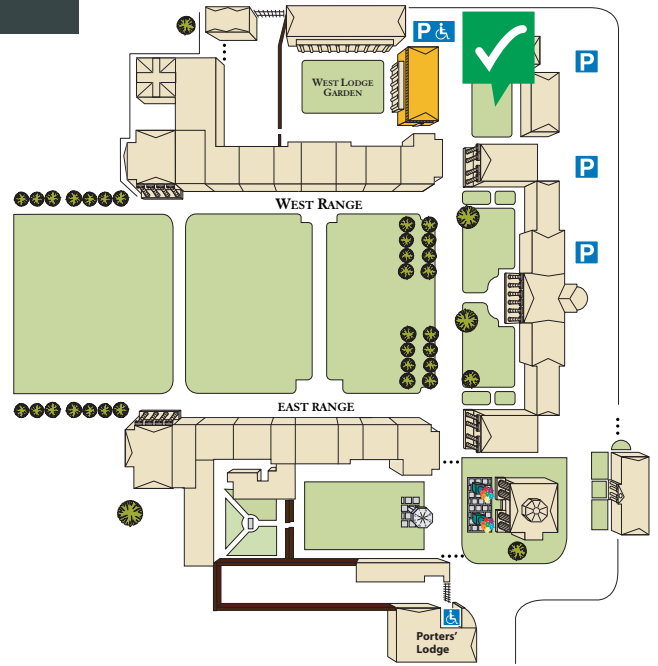

Classroom 60

Cabaret 42

